

FEATURES

- *Stainless steel interior and exterior with galvanised back panel*
- *43°C ambient working temperature*
- *Auto-defrost function*
- *Fan-forced cooling*
- *All European parts, Embarco compressor, EBM fan motor*
- *Carel digital controller*
- *Shelf rails support GN Pans*
- *Gas: R134A for Fridges*
- *Insulation Foam: C5H10,ODP, Zero emissions*
- *Castors as standard*
- *Pre-installed mid-shelves*
- *Double-glazed glass hinged doors*
- *Allow 100 mm clearance for air ventilation*



EPF3721



EPF3731



EPF3741



INFORMATION	EPF3721	EPF3731	EPF3741
Capacity	300L	450L	560L
Power	330W	330W	350W
Voltage	220~240V/50Hz	220~240V/50Hz	220~240V/50Hz
Working Temp	-2°C~+8°C	-2°C~+8°C	-2°C~+8°C
Ambient Temp	43°C	43°C	43°C
Dimensions(mm)	W1360 x D700 x H838,100kg	W1795 x D700 x H838,125kg	W2230 x D700 x H838,162kg
Packaging Dimensions(mm)	W1414 x D765 x H872,133kg	W1849 x D765 x H872,165kg	W2284 x D765x H872,204kg



2 YEARS WARRANTY ON ALL PARTS & LABOUR
 * EXTRA 2 YEARS WARRANTY ON PARTS WHEN YOU REGISTER WITH US ONLINE

EPF3721

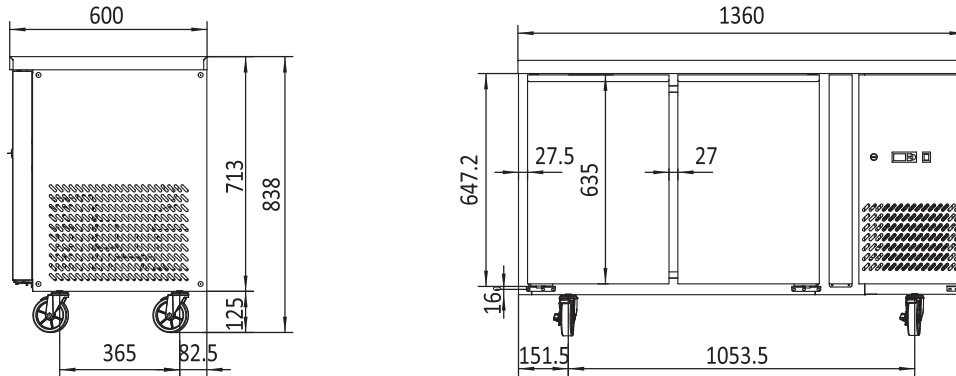

EPF3731

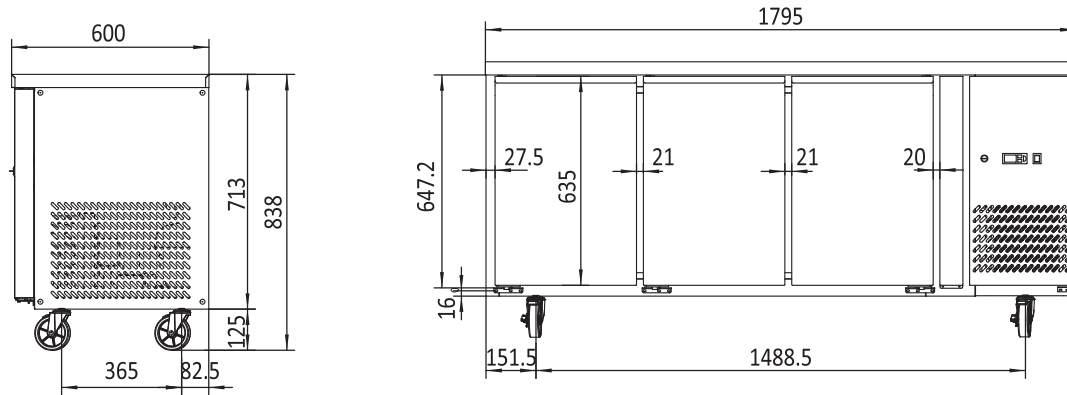

EPF3741

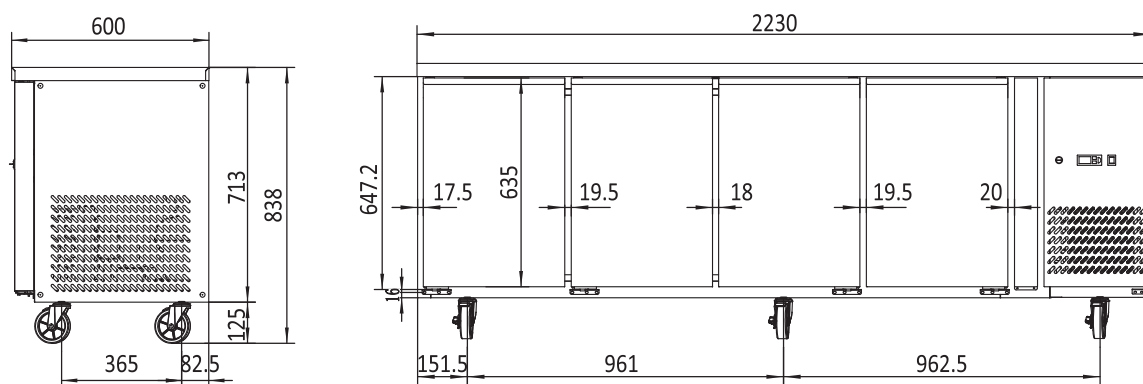

2 YEARS WARRANTY ON ALL PARTS & LABOUR
* EXTRA 2 YEARS WARRANTY ON PARTS WHEN YOU REGISTER WITH US ONLINE